

# 40

GRACECHURCH  
STEC3

**6<sup>TH</sup> FLOOR**  
**12,718 SQ FT**  
**GRADE A**  
**OFFICE SPACE**  
**TO LET**

40

40



**12,718 SQ FT GRADE A OFFICE SPACE TO LET**



40 Gracechurch Street is a high quality, central city office building that was recently redeveloped behind its existing facade. The available accommodation located on the 6th floor and comprises 12,718 sq ft plus 813 sq ft of basement storage space.

## SPECIFICATION

The floor provides a high standard of 'plug and play' space. Amenities include:

Fan coil air conditioning

Metal tile suspended ceiling

LG7 compliant lighting

Raised floors

4 x 17 person passenger lifts

Showers

Cycle storage

'Very Good' BREEAM rating

Basement storage space

Impressive reception



## 6TH FLOOR

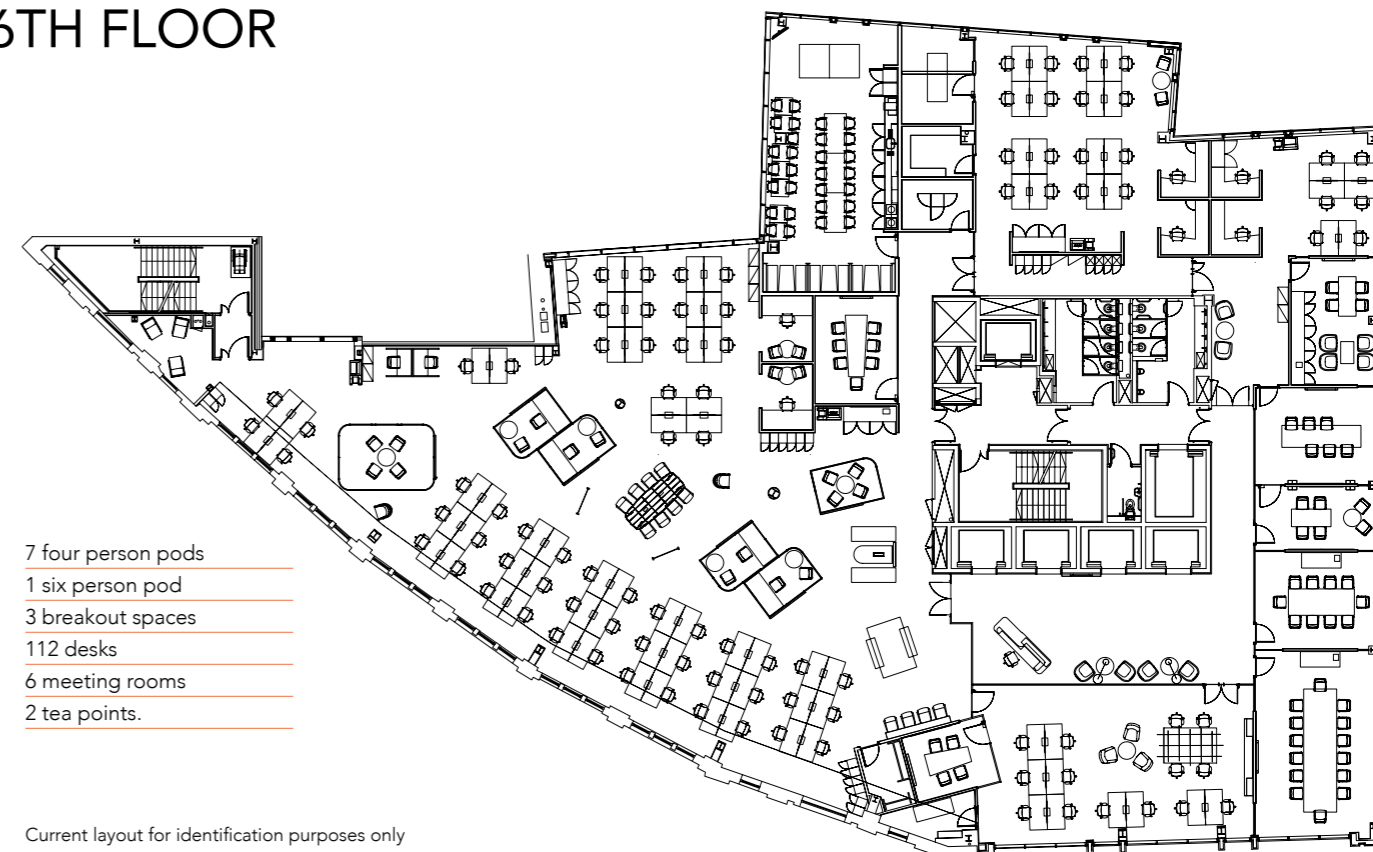

7 four person pods

1 six person pod

3 breakout spaces

112 desks

6 meeting rooms

2 tea points.

Current layout for identification purposes only

# LOCATION

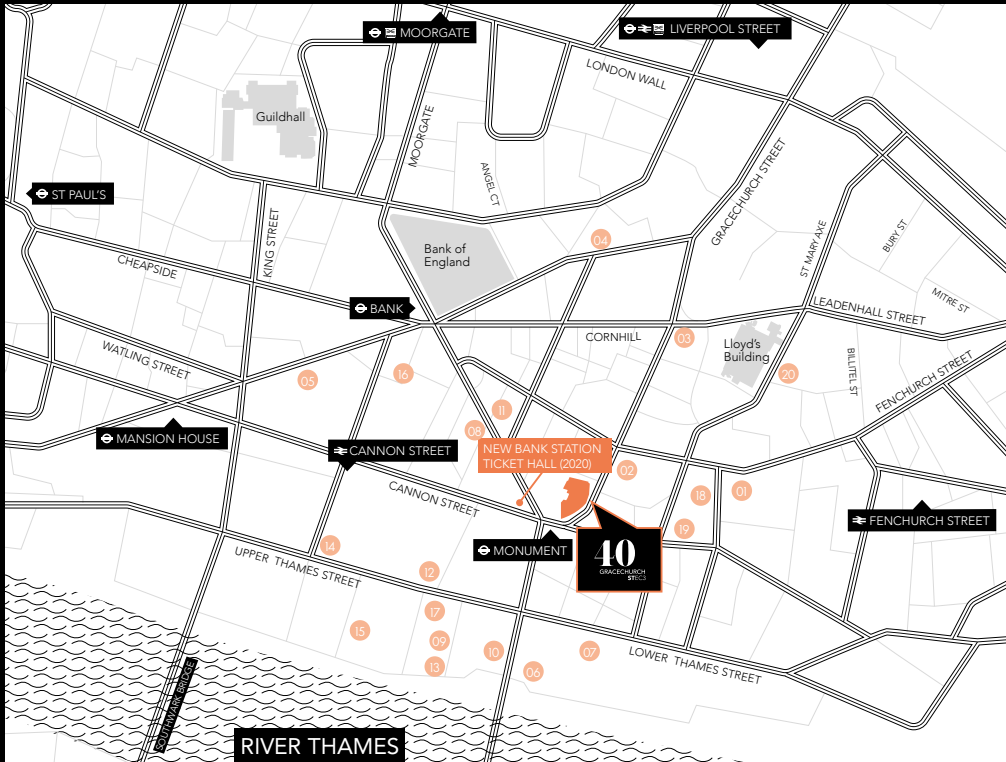

01. Accenture
02. Allianz
03. Amazon (from 2015)
04. Axa
05. Bloomberg (from 2017)
06. BLP
07. Clarksons
08. Daiwa Securities
09. Field Fisher Waterhouse
10. Groupon
11. ICBC
12. M&G
13. Man Group
14. Natixis
15. Nomura
16. Rothschild Group
17. Royal Bank of Canada
18. RSA
19. Tokio Marine Kiln
20. Willis

300m  
from the  
Bank of  
England



3 tube  
stations  
within  
7 mins



## TERMS

On application

## VIEWING

For further information or to arrange a viewing, please contact us on:

**bbg**  
real estate advisers

Tom Boggis  
Jack Wells  
Ph: 020 3713 1950

**CUSHMAN & WAKEFIELD**

James Heyworth-Dunne  
Emma Stratton  
Ph: 0203 296 4283

Misrepresentation Cushman and Wakefield give notice that (i) the particulars are set out as a general outline only for the intended guidance of intended purchasers or lessees, and do not constitute any part of an offer or contract; (ii) all descriptions, dimensions, reference to condition and necessary permissions for use and occupation, and other details are given without responsibility and any intending purchasers or tenants should not rely on them as statements or representations of fact but must satisfy themselves by inspection or otherwise as to the correctness of each of them; (iii) no person in the employment of Cushman and Wakefield has any authority to make any representation or warranty whatever in relation to this property; (iv) space planning contained in this brochure is indicative only and may require modifications to the building design. September 2017.